

## 20 393 001 COSTA L PILLAR TAP

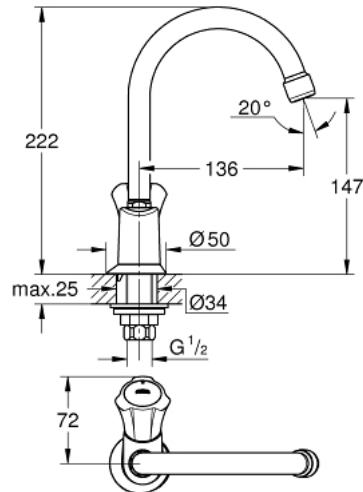

### PRODUCT DESCRIPTION

- Colour: chrome
- metal handle
- heat-insulated
- screwable
- marking: blue
- GROHE Long-Life headpart
- swivelling tubular spout with Mousseur
- union nut 1/2" with 10,5 mm-bore
- GROHE Long-Life finish



## 20 393 001 COSTA L PILLAR TAP

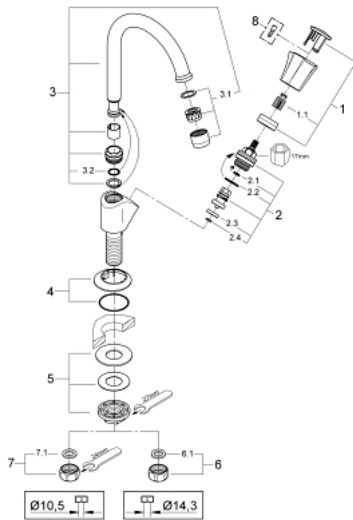

### SPARE PARTS, ธันวาคม 2007 – now

- 1: Handle (Order-nr. 45994000)
  - 1.1: Repl. kit f.handle fastening (Order-nr. 0538600M)
  - 2: Headpart 1/2" (Order-nr. 07146000)
  - 2.1: O-ring  $\phi 6 \times \phi 2$  (Order-nr. 0128300M)
  - 2.2: O-ring  $\phi 18.2 \times \phi 1.7$  (Order-nr. 0392400M)
  - 2.3: Ball seal dia. 9x6.8 mm (Order-nr. 0529100M)
  - 3: Spout (Order-nr. 13219000)
  - 3.1: Mousseur (Order-nr. 13928000)
  - 3.2: O-ring dia. 12x2 mm (Order-nr. 0128000M)
  - 4: Escutcheon (Order-nr. 45996000)
  - 5: Shank mounting kit (Order-nr. 45004000)
  - 6: Coupling nut 1/2" x 14.5 mm (Order-nr. 1290200M)
  - 6.1: Fibre seal dia. 12x2 mm (Order-nr. 0138900M)
  - 7: Coupling nut 1/2" x 10.5 mm (Order-nr. 1290100M)
  - 7.1: Fibre seal dia. 12x2 mm (Order-nr. 0138900M)
  - 8: Screw for Costa/Avina products (Order-nr. 48013000)\*
- \* Optional accessories