

## 26 075 DC0 EUPHORIA SYSTEM 310 SHOWER SYSTEM WITH THERMOSTATIC MIXER FOR WALL MOUNTING

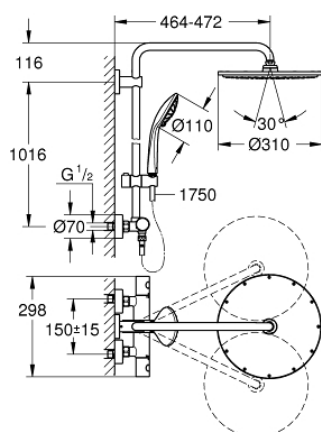

### PRODUCT DESCRIPTION

- Colour: Supersteel
- consists of:
  - Horizontal swivable 450 mm shower arm
  - exposed thermostat with Aquadimmer function
  - allows change between:
    - Rainshower Cosmopolitan 310 metal head shower
    - spray pattern: Rain
    - with ball joint
    - angle of rotation  $\pm 15^\circ$
    - hand shower Euphoria 110 Massage
  - 3 adjustable sprays
  - Rain, Massage, SmartRain
  - maximum flow rate (at 3 bar): 13.5 l/min
  - adjustable in height with gliding element
  - shower hose Silverflex 1750 mm 1/2" x 1/2" (28 388)
  - GROHE TurboStat compact cartridge with wax thermoelement
  - GROHE SafeStop at 38°C
  - GROHE SafeStop Plus optional temperature limiter at 43°C included
  - GROHE MetalGrip ergonomically shaped metal handles
  - GROHE DreamSpray perfect spray pattern
  - GROHE Long-Life finish
  - GROHE SprayDimmer (Stepless flow rate reduction)
  - Inner WaterGuide for a longer life
  - SpeedClean anti-lime system
  - TwistStop (to prevent hose from twisting)
  - suitable for instantaneous heaters (min. 19 kW/h)
  - minimum flow rate 5 l/min.
  - optional upgrade: GROHE EasyReach tray (26 362), sold separately

## 26 075 DC0 EUPHORIA SYSTEM 310 SHOWER SYSTEM WITH THERMOSTATIC MIXER FOR WALL MOUNTING

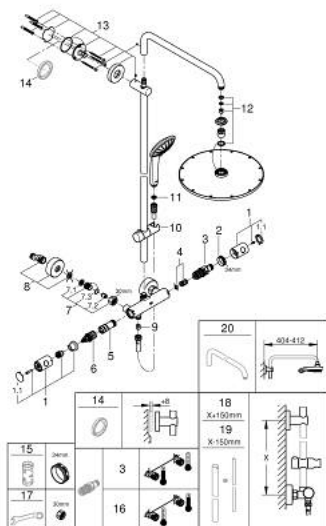

### SPARE PARTS, กรกฎาคม 2017 – now

- 1: Costa metal handle 1/2" (Order-nr. 47984DC0)
- 1.1: Cap (Order-nr. 64585DCM)
- 2: Fitting ring (Order-nr. 47743000)
- 3: Thermostatic compact cartridge 1/2" (Order-nr. 47439000)
- 4: Sound absorber (Order-nr. 47398000)
- 5: Water flow (Order-nr. 47751000)
- 6: Aquadimmer (Order-nr. 12433000)
- 7: Non-return valve (Order-nr. 47189DC0)
- 7.1: Dirt Strainer (Order-nr. 0726400M)
- 7.2: Non-return valve (Order-nr. 08565000)
- 7.3: O-ring  $\phi 17 \times \phi 2$  (Order-nr. 0305500M)
- 8: S-union (Order-nr. 12662DC0)
- 9: Non-return valve (Order-nr. 08565000)
- 10: Sliding piece (Order-nr. 12140DC0)
- 11: Dirt strainer (Order-nr. 0700200M)
- 12: Inlet valve assembly (Order-nr. 45933000)
- 13: Outlet shower holder (Order-nr. 48279DC0)
- 15: Socket spanner (Order-nr. 19332000)\*
- 16: GROHE TurboStat cartridge 1/2" (Order-nr. 47175000)\*
- 17: Special spanner (Order-nr. 19377000)\*

\* Optional accessories