

27 473 002 EUPHORIA SYSTEM 260 SHOWER SYSTEM WITH SINGLE LEVER MIXER FOR WALL MOUNTING

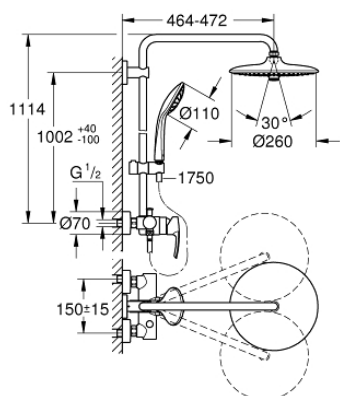

PRODUCT DESCRIPTION

- Colour: chrome
- consists of:
 - Horizontal swivable 450 mm shower arm
 - Exposed single-lever shower mixer with diverter
- allows change between:
 - head shower Euphoria 260 (26 457)
- 3 adjustable sprays
 - Rain, SmartRain, Jet
- with ball joint
- angle of rotation $\pm 15^\circ$
- hand shower Euphoria 110 Massage (27 239 000)
 - 3 adjustable sprays
 - Rain, Massage, SmartRain
 - adjustable in height with gliding element
- shower hose Silverflex 1750 mm(28 388)
- GROHE SilkMove 46 mm ceramic cartridge
- GROHE DreamSpray perfect spray pattern
- GROHE Long-Life finish
- GROHE SprayDimmer (Stepless flow rate reduction)
- GROHE Water Saving 9.5 l/min flow limiter
- GROHE FastFixation upper bracket adjustable
- Inner WaterGuide for a longer life
- SpeedClean anti-lime system
- TwistStop (to prevent hose from twisting)
- suitable for instantaneous heaters (min. 19 kW/h)
- minimum flow rate 7 l/min.
- minimum pressure 1,0 bar
- professional edition

27 473 002 EUPHORIA SYSTEM 260 SHOWER SYSTEM WITH SINGLE LEVER MIXER FOR WALL MOUNTING

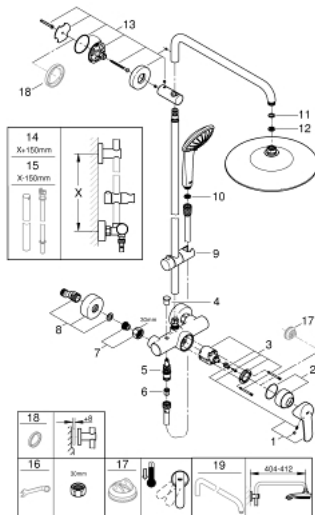

SPARE PARTS, มกราคม 2020 – now

- 1: Lever (Order-nr. 46726000)
- 2: Shield (Order-nr. 46025000)
- 3: Cartridge (Order-nr. 46048000)
- 4: Diverter knob (Order-nr. 65648000)
- 5: Diverter (Order-nr. 65655000)
- 6: Non-return valve (Order-nr. 08565000)
- 7: Screw joint (Order-nr. 45044000)
- 8: S-union (Order-nr. 12662000)
- 9: Sliding piece (Order-nr. 12140000)
- 10: Dirt strainer (Order-nr. 0700200M)
- 11: Fibre seal dia. 12x2 mm (Order-nr. 0138900M)
- 12: Dirt strainer (Order-nr. 48007000)
- 13: Outlet shower holder (Order-nr. 48279000)
- 14: Shower system pipe for retrofitting (Order-nr. 48514000)*
- 15: Shower system pipe for retrofitting (Order-nr. 48515000)*
- 16: Special spanner (Order-nr. 19377000)*
- 17: Temperature limiter (Order-nr. 46375000)*
- 18: Compensation disc (Order-nr. 27180000)*
- 19: Shower arm for shower systems (Order-nr. 14047000)*
- * Optional accessories