

## 31 187 001 COSTA L WALL SINK MIXER 1/2"

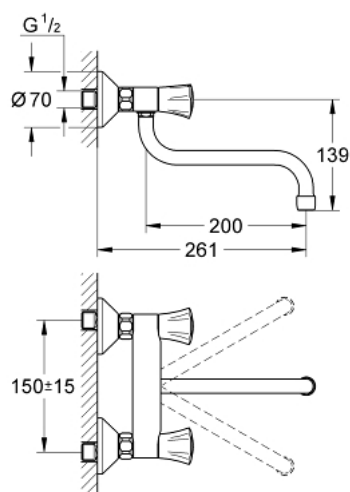

### PRODUCT DESCRIPTION

- Colour: chrome
- metal handles
- heat-insulated
- GROHE Long-Life finish
- GROHE Long-Life headparts
- mousseur
- selectable swivel area : 0° / 150° / 360°
- projection 203 mm
- S-unions
- maximum flow rate (at 3 bar): 13 l/min



## 31 187 001 COSTA L WALL SINK MIXER 1/2"

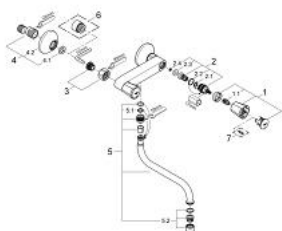

### SPARE PARTS, มิถุนายน 2007 – now

- 1: Handle (Order-nr. 45994000)
  - 1.1: Repl. kit f.handle fastening (Order-nr. 0538600M)
  - 2: Headpart 1/2" (Order-nr. 07146000)
  - 2.1: O-ring  $\phi 6 \times \phi 2$  (Order-nr. 0128300M)
  - 2.2: O-ring  $\phi 18.2 \times \phi 1.7$  (Order-nr. 0392400M)
  - 2.3: Ball seal dia. 9x6.8 mm (Order-nr. 0529100M)
  - 3: Screw joint (Order-nr. 45044000)
  - 4: S-union (Order-nr. 12075000)
  - 4.1: Ball seal dia. 9x6.8 mm (Order-nr. 0138600M)
  - 4.2: Escutcheon (Order-nr. 0221000M)
  - 5: Swivel tube spout (Order-nr. 13051000)
  - 5.1: O-ring dia. 12x2 mm (Order-nr. 0128000M)
  - 5.2: Mousseur (Order-nr. 13928000)
  - 6: Extension 3/4", 20 mm (Order-nr. 0713000M)\*
  - 7: Screw for Costa/Avina products (Order-nr. 48013000)\*
- \* Optional accessories